

# Key Information

## Key Contacts:

Tapton School email: [enquiries@taptonschool.co.uk](mailto:enquiries@taptonschool.co.uk)

## Admissions Process:

Please note Tapton School admissions follow the Sheffield Local Authority policy and applications for a place at Tapton need to be directed to Secondary Admissions for Sheffield. Please use the contact below the Local Authority on: [ed-admissions@sheffield.gov.uk](mailto:ed-admissions@sheffield.gov.uk)

## Our School Uniform:

In Tapton all pupils wear our uniform with pride:

- Tapton logoed polo shirt/long-sleeved in white or black or a plain white or black school wear polo shirt and Tapton logoed black sweatshirt or Tapton logoed black cardigan.
- Students can wear either flat black full-length trousers, black tailored shorts or a black skirt. Students cannot wear jogging bottoms or leggings. Trousers (such as cargo trousers) with cuffed legs are also not allowed.
- All black shoes or trainers without any coloured logo and without different coloured trims (not sandals) or flat all black below the knee boots.

## Examination Results:

Our examination results have been published on our school website, please use the information below:  
[www.taptonschool.co.uk](http://www.taptonschool.co.uk), click on Joining Our School, click on Exam and Assessment Results.

## Feedback:

Please complete an online form to provide us with feedback on your experience of our Year 6 Open Evening. Either by typing in the following link <https://forms.office.com/e/NzZCev7KD8> or using the QR Code:

Tapton School Year 6 Open  
Evening Feedback



# Tapton SCHOOL

## Year 6 Open Evening

Wednesday 4<sup>th</sup> October 2023

6pm until 8pm



Valuing Everyone  
Caring for Each Other  
Achieving Excellence

# The Tapton Seven

**Excellence is a habit; we are what we repeatedly do**

- 1** We are responsible for the world around us
- 2** We are kind
- 3** We work hard
- 4** We follow the rules
- 5** We are responsible for our learning journey
- 6** We make the most of the resources available to us
- 7** We believe we are all capable of excellence

**Tapton**  
SCHOOL

## Preparation for Year 7

As a year 6 student there are lots of ways you can get ready for secondary school.

Here are some ideas based on our experience:

- Have a good routine for homework in place with a place to study at home – you will get more homework in Year 7 so good habits now will pay off.
- Practise the journey to school so you feel confident – walk the route or take the bus, work out who you will travel with.
- Learn how to tell the time – punctuality is important. A watch is a good idea as you won't be allowed to use your phone in the school building at Tapton.
- Once you know you have a place at Tapton in March you should purchase your uniform from Pinders. Their website provides lots of details about our school uniform and P.E Kit <https://pindersschoolwear.com/>
- Carry a rucksack with you to Primary School. Remember you will be travelling around the school as your lessons will be taught in different classrooms.
- Have a look at the different equipment you will need. At Tapton we encourage students to use a planner, to have a pencil case with ruler, rubber, pencil. We write in black pens only.
- Try to become more independent and take responsibility for yourself. For example, keep a calendar for what's coming up this year, pack your own bags for holidays, fill up your own water bottle and pack it in your school bag.

If you would like to speak to Tapton School please contact us through [enquiries@taptonschoolco.uk](mailto:enquiries@taptonschoolco.uk)

## Our Curriculum

Our ambitious and bespoke curriculum is designed to allow all students to realise their life chances and dreams. Inclusion and destinations drive all our decision making. We aim to ensure that every child is fully engaged in learning and gains and retains a deep body of knowledge. This ensures they are ready for a successful transition to the next stage of learning and onwards to employment.

**We value everyone, care for each other and achieve excellence.**

Every child has the right to a broad and balanced curriculum with a quality experience in the Arts, Technology, Science, Religious Education, Physical Education, a Modern Foreign Language and the Humanities, alongside a strong core subject experience in English and Maths.

The school is committed to a 3 year KS3 experience. At every key stage we build the composite knowledge and skills for progress and future success. Our broad, knowledge rich curriculum ensures engagement and allows students to discover their own passions and make appropriate learning and life choices. Our vision is to embed cultural capital across all groups.

We believe the heart of our curriculum must be academic because this is the best guarantee for student destinations and removes obstacles for social mobility. Our curriculum offer is personalised to the individual needs of young people, particularly those at risk of disengagement and exclusion. As a Vision Support school we deliver independent living skills for VI students and where appropriate other students with high needs.

We are a values driven school that celebrates the diversity of our community. RE is an integral part of the curriculum for every student from year 7 to 11. Universal values of tolerance and understanding are deeply embedded within our RE, Personal Development and Form Time programme as are LGBTQ+, anti-sexism, anti-racism and anti-bullying.

## Key People



**Headteacher - Ms Rhodes**



**Assistant Headteacher**  
Ms Sharman



**Deputy Headteacher**  
Ms Grewal



**Assistant Headteacher**  
Mrs Morris



**Year 7 Year Leader**  
Mr Heath



**Transition Leader**  
Ms Connett



**KS3 Learning & Inclusion**  
Ms Allinson

# Our School Map

## Ground Floor

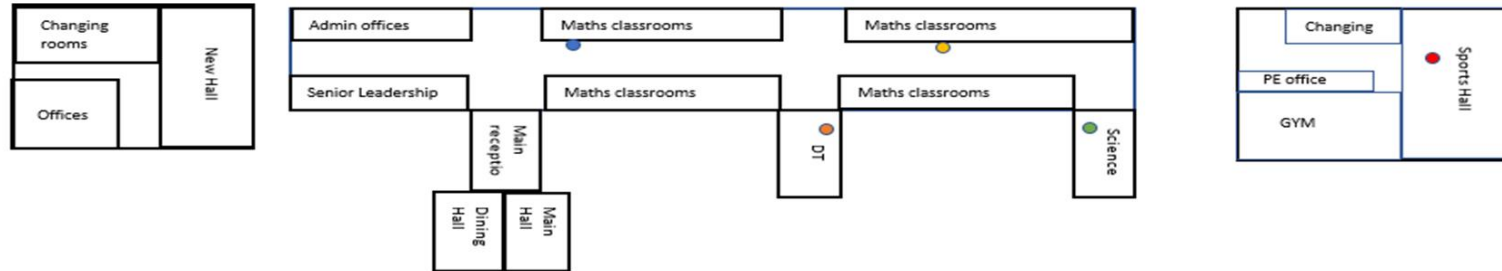

## First Floor

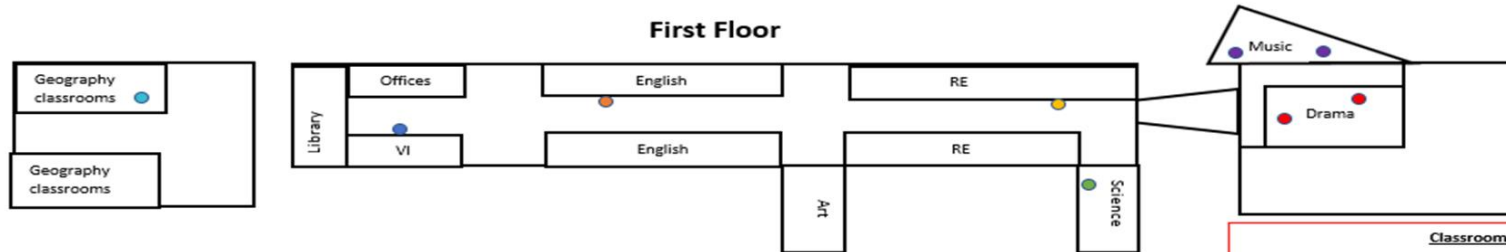

## Second Floor



### Classrooms to visit

- |                             |                     |
|-----------------------------|---------------------|
| <b>Ground Floor</b>         | <b>Second Floor</b> |
| ● Maths                     | ● History           |
| ● Design and Technology     | ● Food              |
| ● Learning Support          | ● MFL               |
| ● Science                   | ● Computer Science  |
| ● P.E – Gym and Sports Hall |                     |
| <b>First Floor</b>          | <b>New Building</b> |
| ● Vision Support            | ● Geography         |
| ● English                   |                     |
| ● R.E                       |                     |
| ● Science                   |                     |
| ● Drama                     |                     |
| ● Music                     |                     |